

# 3900 Metal Lever Switches 16A 250Vac



- ▶ Metal lever switches
- ▶ Ratings up to 20A, 277V ac
- ▶ Single and double pole
- ▶ Choice of circuits including 3 position and momentary
- ▶ 6.3mm and solder terminals
- ▶ Guard option



16(4)A 250Vac T85 (3900 & 3950)  
10(4)A 250Vac T85 (All other circuits)



UL CSA 20A 125/277Vac (ON-OFF Circuits)  
UL CSA 16A 125/277Vac (Other Circuits)  
UL CSA 7A 72Vdc, 14A 36Vdc  
UL 250Vac 1hp, 125Vac 1/2hp  
UL 65°C, file E45221, CSA file LR10990

Inrush rating - Contact factory for details



RoHS compliant

Approvals and ratings vary with function.  
3mm contact gap except where marked  $\mu$ .  
Technical data on pages 4 & 5.

**C 3900 B A - - -**

TERMINAL FUNCTION ACTUATOR BODY OPTIONS

TERMINAL	FUNCTION	ACTUATOR
<p><b>C</b></p> <p>6.3 x 0.8</p> <p>10.5</p>	<p><b>Single pole</b></p> <p><b>3900</b></p> <p><b>3901</b></p> <p><b>3902</b></p> <p><b>3910</b></p> <p><b>3911</b></p> <p><b>3920</b></p> <p><b>3921</b></p> <p><b>3922</b></p>	<p><b>Double pole</b></p> <p><b>3950</b></p> <p><b>3951</b></p> <p><b>3952</b></p> <p><b>3960</b></p> <p><b>3961</b></p> <p><b>3970</b></p> <p><b>3971</b></p> <p><b>3972</b></p>
<p><b>T</b></p> <p>10.5</p> <p>0.31</p> <p>Solder</p>		<p><b>B</b></p> <p>17.5</p> <p>Finish is nickel plate.</p>



C3900BA ---



C3920BA ---



**Guard R17-10**  
Anti-rotation tab can be specified for guard fitted in On or Off position



C3950BB ---



C3972BB ---

**BODY**

**A**  
Without terminal barrier  
Single pole

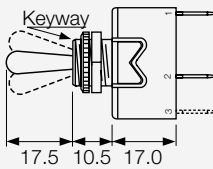

**B**  
With terminal barrier  
Double pole only

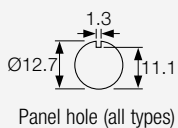
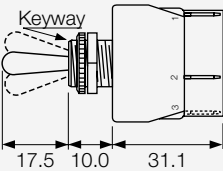

**OPTIONS**

**Neck Seal M539**  
Actuator is visible



**Cover M1080**



Covers have internal nylon nuts

**Fixing nuts**  
Nickel plated brass are supplied

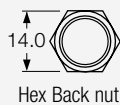

Panel thickness 4.0 with backnut

**DIMENSIONS** (mm) \* Indicates ON position (for ON - OFF switches)

**Single Pole**  
(C terminals shown)

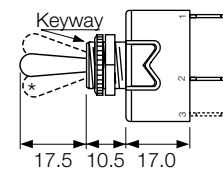
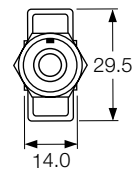

Optional  
P232 plate  
SP or DP

**Double Pole**  
(C terminals shown)

